

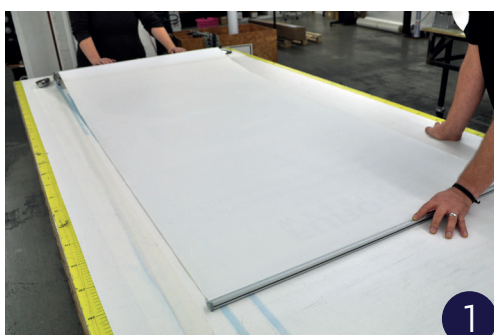

Displays

Instructions Roll Up High Q.

RollUp-Print uninstall:



Unreel the banner completely and hold it tight (two persons!)



Take the key from the lateral cover

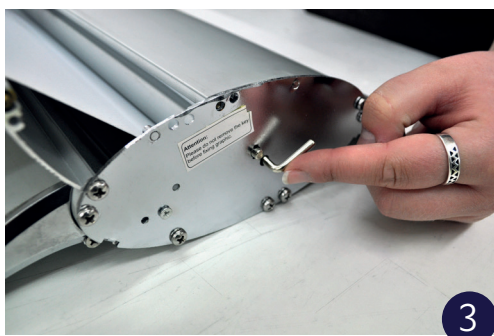

Insert the key (the banner is arrested)

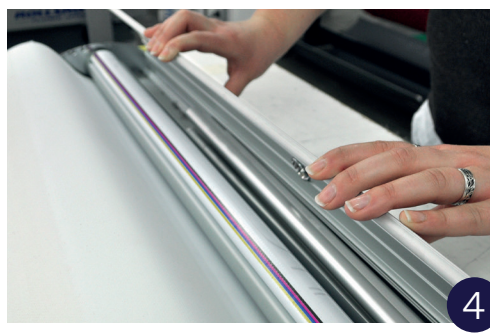

Open the base unit



Open the bar inside the base unit



Remove the banner

Displays

Instructions Roll Up High Q.

new RollUp-Print install:



1
Open the base unit and take the telescope bar as well as the fixation bar



2
Remove the plastic caps from the fixation bar



3
Open the fixation bar



4
Place the banner straight frontside up into the bar (top edge of the banner) and close the bar*



5
Put the plastic caps back on the bar and turn the banner (backside up)



6
Open the bar inside the base unit



7
Place the banner straight into the bar (lower edge of the banner)



8
Close the bar*

Displays

Instructions Roll Up High Q.

new RollUp-Print install:



9

Open the lateral cover of the base unit on the right and left side (viewed from the front)



10

There is a key on the right side.
ATTENTION: Leave the key still in the base unit!



11

Turn the banner carefully by shifting it above the base unit



12

Hold the banner tight

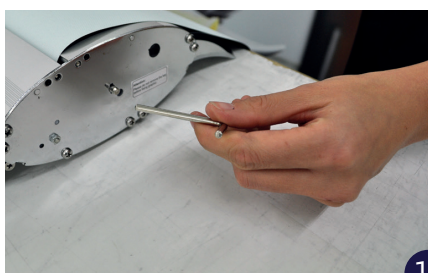

13

Remove the key by holding the banner



14

By turning the wheel on the left clockwise....



15

....roll the banner carefully into the base unit

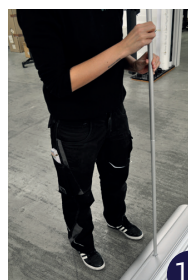

16



17

Fix the telescope bar in the base unit.
Adjust the height and clip the banner on the top with the fixation bar



Displays

Instructions Roll Up High Q.

IMPORTANT:



wrong!



Right: Place the banner always straight and without buckles!



wrong!

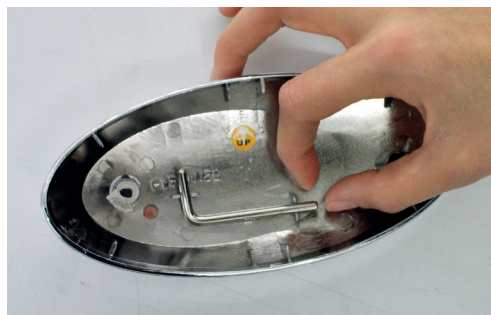

Keep the key inside the lateral cover of the base unit

*NOTE : To close the bar always press from the center outwards!

